



Flash 3300 air inlet

The air inlet Flash 3300 represents a revolutionary evolution in terms of air control. The air flow can be directed into the building in an optimal pattern regardless of the opening of the inlet.

This air inlet has proven its value in hundreds of houses around the world and also right here in Ontario. It can be used for all types of livestock facilities and is particularly well suited to all poultry & hog applications.

Advantages

- ▶ The Flash steers the incoming fresh air before it enters the building.
- ▶ The spoilers can be adjusted to suit the application and can be modified at any time if a change is desired. Normally this happens once when the barn is set up with a smoke test.
- ▶ When used in wide houses, the Flash steers the air further into the barn improving minimum ventilation. The bottom spoilers could be used to direct air over the birds in a broiler application.
- ▶ Avoiding of obstacles in the house, like cages, laying nests and construction beams
- ▶ No airflow in the nests.
- ▶ The amount of air is regulated with a vertical, well insulated slide. The frame of the inlet is also insulated to prevent ice build-up.

- ▶ **Patented**
- ▶ **Flexible air flow**
- ▶ **Simple Mounting**
- ▶ **Reliable**
- ▶ **Insulated**
- ▶ **Low transport costs**
- ▶ **Doesn't freeze easily**

**Watch the Flash in action and look to the videos at
www.tulderhof.com**

Technical information

Flash 3300 air inlet - information

Type	F-3300
0.0401 WC [inch]	1413 cfm
0.0802 WC [inch]	1942 cfm
0.1204 WC [inch]	2413 cfm
Surface - in ²	243,35
Width - inches	22,835 *
Height - inches	15,354
Depth - inches	2,362

* Width can be changed to a minimum of 22.44" by cutting off clips on the ends. This allows installation between wall studs.

Please Note:

The position of the spoilers has a big impact on the capacity of the air inlet. The picture on the right illustrates this for the Flash 3300. It is advised to calculate the airflow using 0.0401" W.C.



The Flash 3300 is also available in a daylight version. Please contact us to see if this product is suitable for your application.

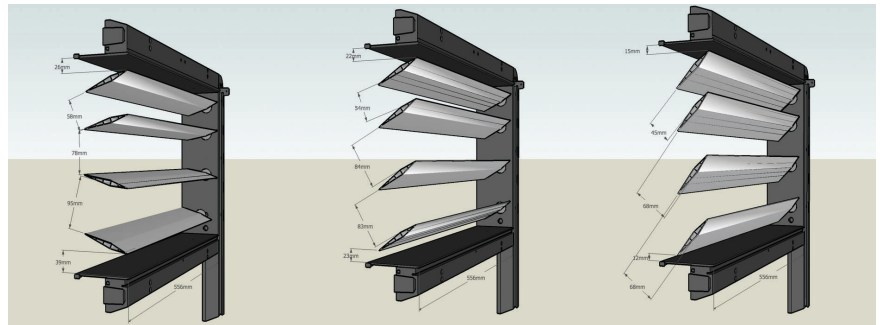

Spoilers normal

Surface - 243,35 in²
 0,0401 WC [inch] - 1413 cfm
 0,0802 WC [inch] - 1942 cfm
 0,1204 WC [inch] - 2413 cfm

Spoilers up

Surface - 229,40 in²
 0,0401 WC [inch] - 1236 cfm
 0,0802 WC [inch] - 1766 cfm
 0,1204 WC [inch] - 2148 cfm

Spoilers up extreme

Surface - 178,25 in²
 0,0401 WC [inch] - 1030 cfm
 0,0802 WC [inch] - 1442 cfm
 0,1204 WC [inch] - 1766 cfm

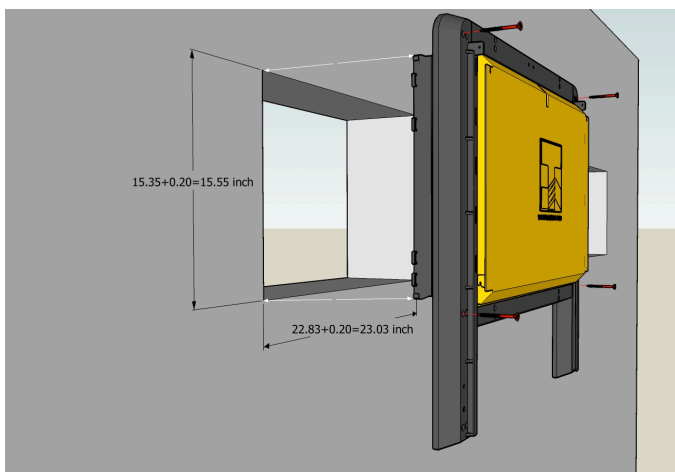

CountyLine

8582 Hwy 23 N., Listowel, ON
 Ph: 800-463-7622 Fax: 519-291-5816
 Internet: <http://www.county-line.ca>
 Email: sales@county-line.ca